

Case Study

The purpose of case study is to inform our capacity and skill set to manufacture and install customized design office furniture. Modular office furniture is unique to every office with respect to design and specifications. We take the challenges as what the customers wishes. The process to take up the customization involves understanding the requirement, giving tentative costing, putting mock up of a typical cluster, color selection and then installation of the same. This cycle normally takes 3 to 7 weeks depending on the complexity of the design. The customization normally includes type of partition, shape of table, storage design and other relevant accessories. The price does increase per seater whenever the component of customization is involved and the level of it.

- 1
 - Frame 75mm thick below the table top.
 - 120 Degree workstation of size 1200mm X 1200mm x 750 mm depth.
 - Front magnetic privacy panel of 18mm thick and 300mm height.
- 2
 - Gable end special profile is 1200mm height.
 - Two module tile above top. Metal perforated tile below.
 - Corner top size 1475mm / 1475mm and straight is 1175mm / 600mm.
- 3
 - Table is supported with metal powder coated legs.
 - Corner top size 1500mm X 1100mm X 600mm depth.
 - Thickness of frame 75mm and height is 1200mm.
- 4
 - Frame thickness of 32mm and height 450mm.
 - Flip box of 450mm taken.
 - Conference table 43mm thick with special legs.
- 5
 - Front magnetic privacy panel 18mm thick and 300mm height.
 - Four equal drawer table supported.
 - Corner workstation frame of 50mm thickness and 1200mm height.

Case Study-1





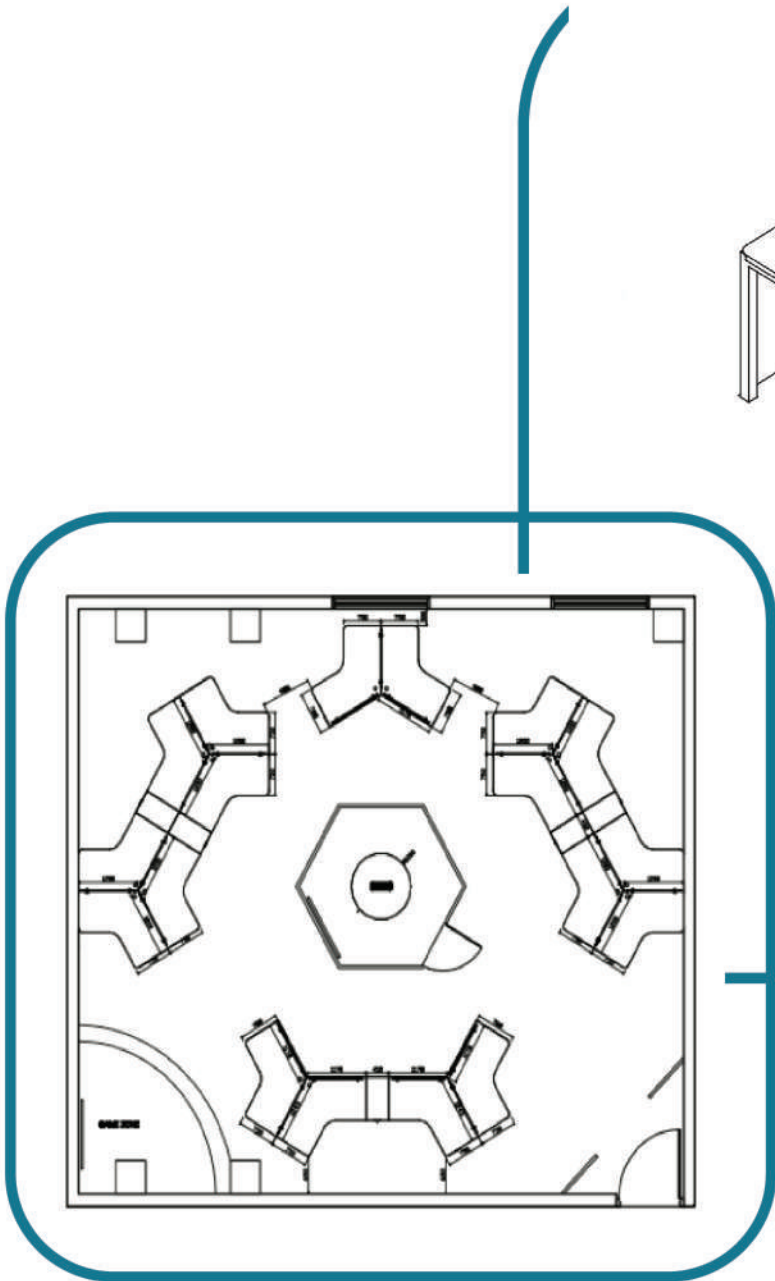

120 Degree table top

18mm Thick magnetic fabric panel

Metal 50 X 50 leg

Metal 75mm thick raceway frame with prelam tile

Case Study-2





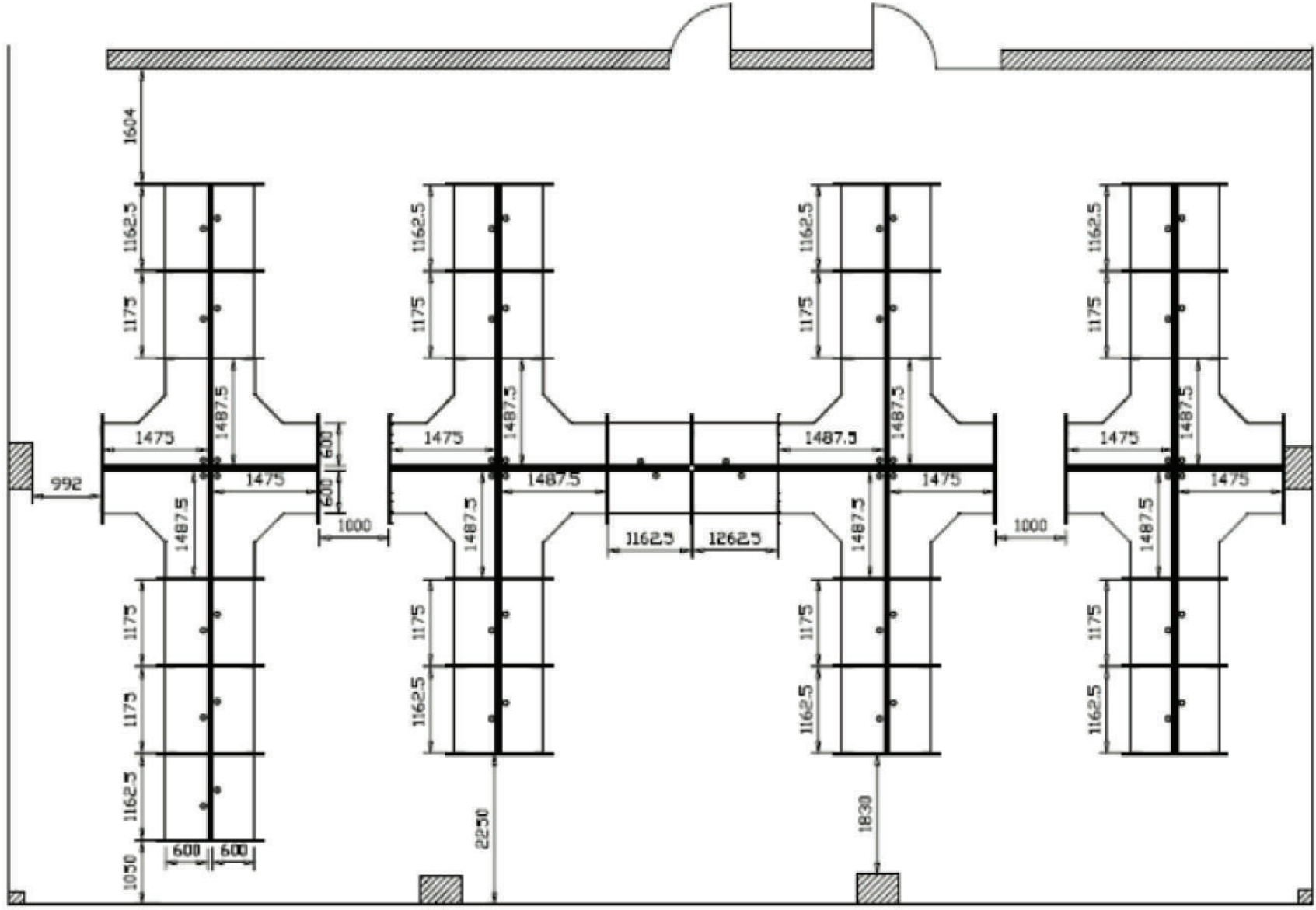



Case Study-3





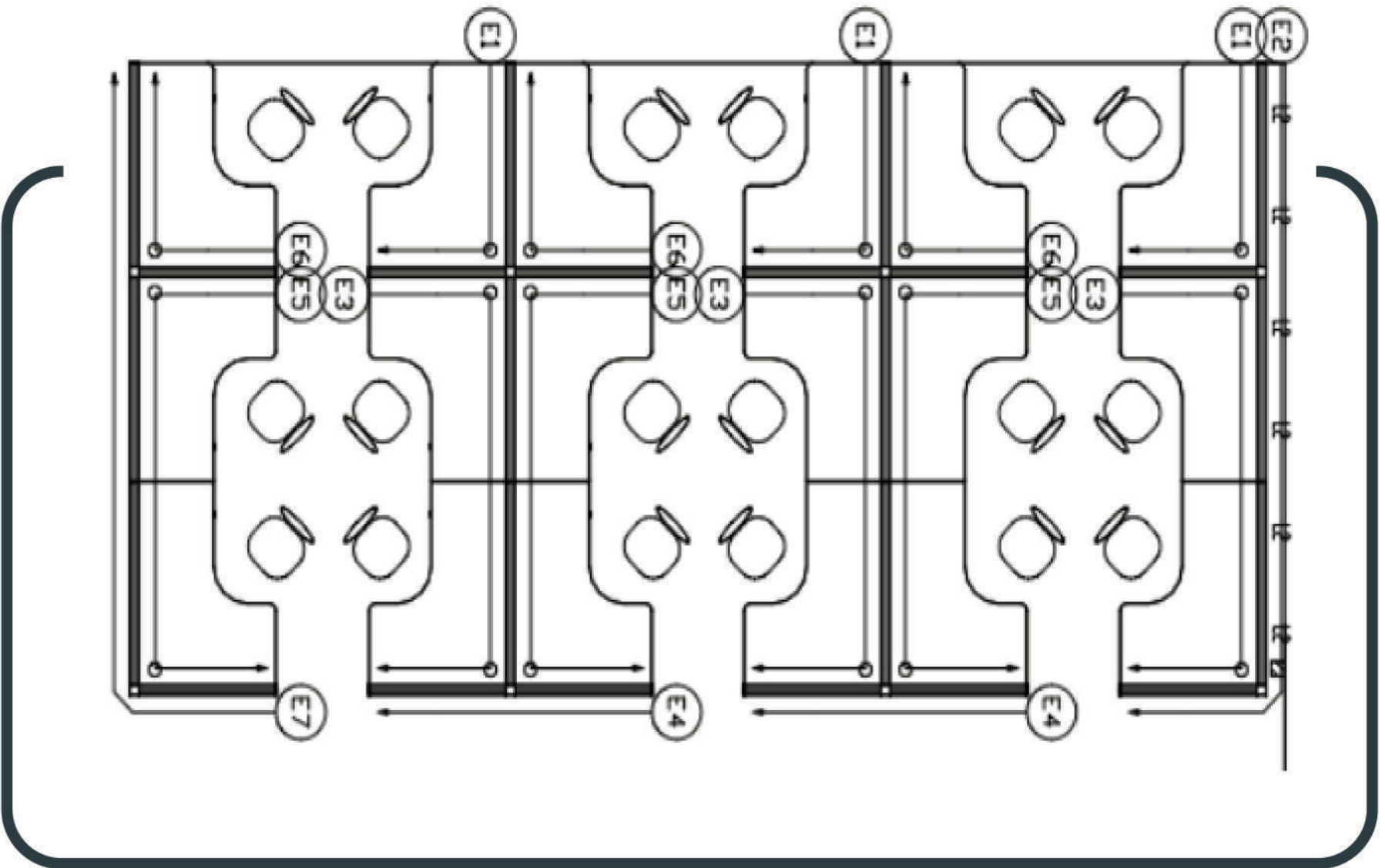



Case Study-4



Smart Desk
Solutions in Office Furniture



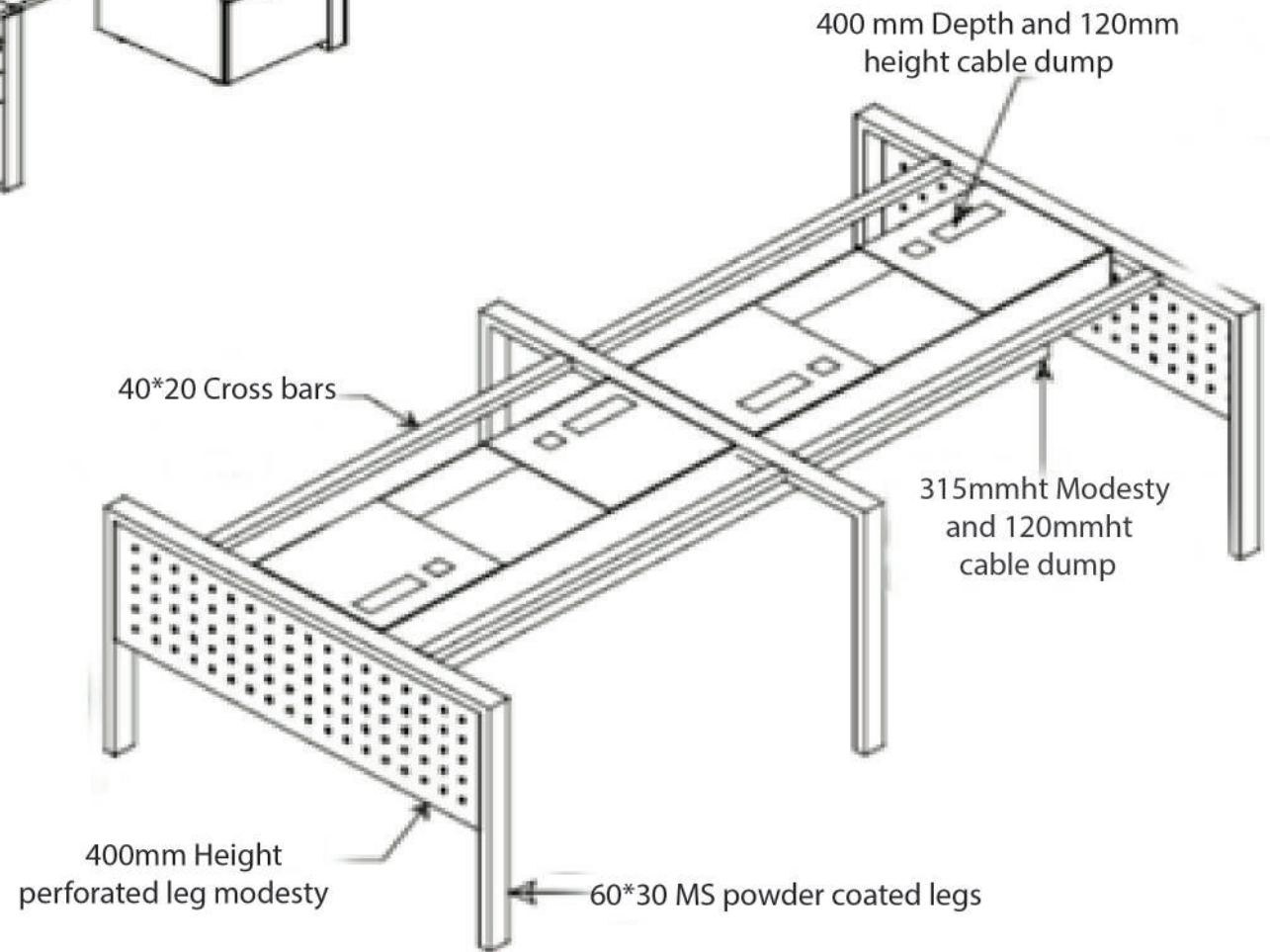
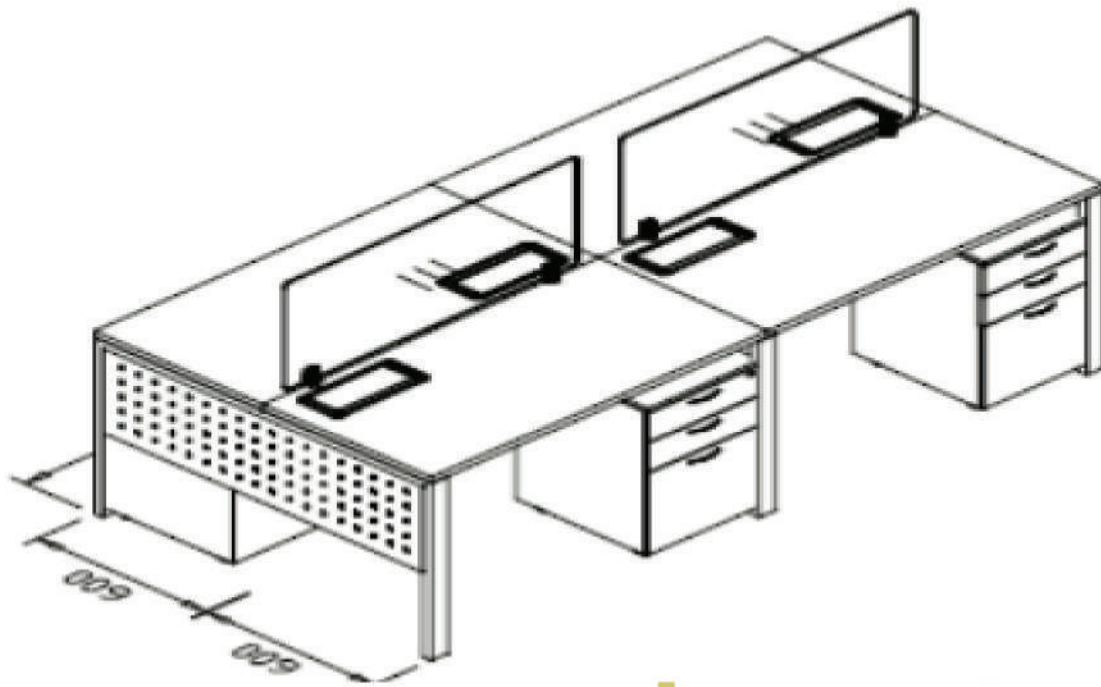



Case Study-5





